

CONTAINERCHAIN

THE SINGLE WINDOW FOR CONTAINER LOGISTICS

DRIVER eGate for Smartphone

A User Guide for Transport Operators



Table of Contents

1.	<u>Introduction</u>	2
2.	<u>Install the Driver App</u>	3
2.1	Minimum requirements	2
2.2	Download Driver	3
2.3	Company & User Login Credentials	3
2.4	How to Login to the App	4
3.	<u>Operations</u>	4
3.1	Dehire Notification	4
3.1.1	Green Lane	5
3.1.2	Red Lane	7
3.2	Pick up Notification	8
3.2.1	Green Lane	8
3.2.2	Red Lane	10
3.3	Multiple Jobs	11
3.3.1	Green Lane	11
3.3.2	Red Lane	13
3.4	Rejecting a Job	14
3.5	Logout	14

1. Introduction

Driver@Containerchain is a mobile 'app' that works on a handheld device (such as smartphone and tablet) for the truck drivers. This app communicates real-time run sheet details to the driver, automatically updating the Fleet Controllers with job status and truck whereabouts. In addition, Empty Container Depots can automatically process arriving trucks with no paperwork, or manual intervention, streamlining the entry into the gate promoting faster turnaround through the depot.

2. How to Install the Driver App

2.1 Minimum requirements

The Driver app is designed and compatible on iOS and Android smartphones and tablets. Below are the minimum requirements that need to be met to run the app on iOS and Android mobile devices.

iOS:

Minimum required OS: 6.0

Recommended OS version: 8.0 and above

Android:

Minimum required OS version: 4.2.2 (Jellybean)

Recommended OS version: 4.4.4 (Kitkat)

2.2 Downloading Driver

Search for “Containerchain” in the App Store, or on Google Play, and follow the on-screen instructions to download and install. If your device does not meet the minimum requirements (as explained in 2.1), you may not be able to successfully download and install the Driver app.



Apple, the Apple logo, iPhone and iPad are trademarks of Apple Inc. registered in the U.S. and other countries, App Store is a service mark of Apple Inc.



Google Play is a trademark of Google Inc.

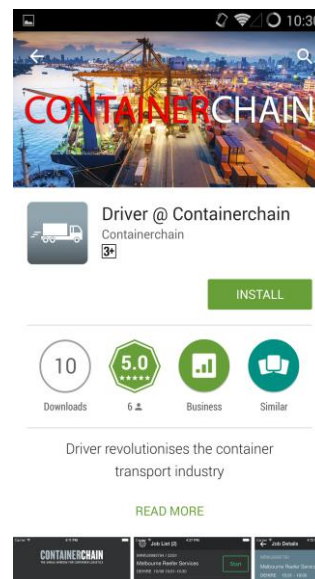
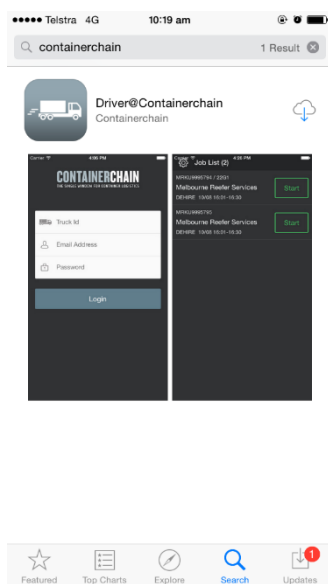

2.2 Company & User Login Credentials

Once you have installed the Driver app, you will need login credentials to use it. To obtain a login for your company and your individual drivers please call Containerchain Support on **1300 944 083** and provide the below information;

- Full Name
- Company Account ID (MAX ID)
- Email Address

Containerchain will provide you with a company profile, and login details for each truck and driver.

2.3 How to Login to the App

Once you receive the login details from Containerchain Support, please input your Truck ID (Registration number), Email address, Password and click Login. Each truck registration and driver will need to have their own login credentials.

Please note the disclaimer upon login.

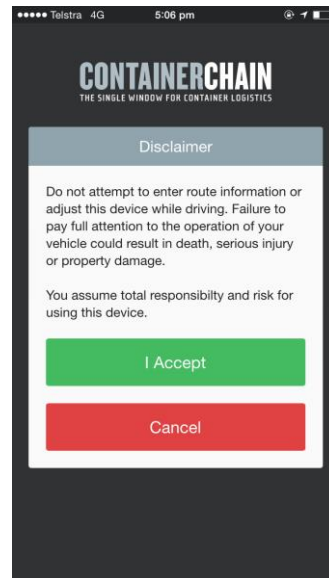
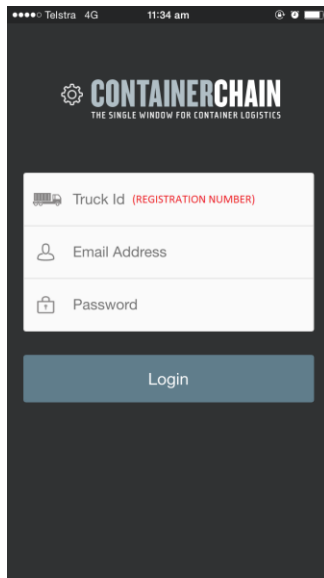

3. Operations

3.1 Dehire Notification

When a Fleet Controller enters a pickup notification into the Containerchain notification website, the job is automatically sent to the app logged in under that truck registration (Step 2.3). To accept a job, tap 'Start' button. A prompt will appear and ask if you are sure you want to accept & start selected jobs, press 'Yes' to continue.

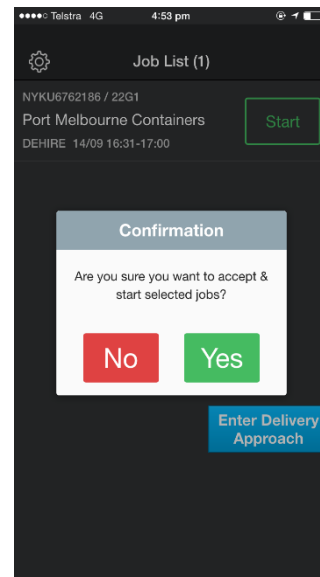
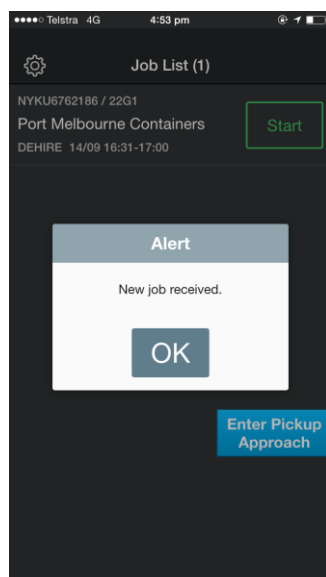

First step will be to confirm the container number on the job that you have just accepted. Press the 'Confirm' button on the job. This will take you to an 'Arrived: Pickup location' page.

Tapping 'Manual Load' and then 'Manual Depart' will confirm the container number on the job is correct and you are ready to set off towards the dehire location. The status tag of the job will now change to 'Confirmed', you may now proceed towards the empty container depot.

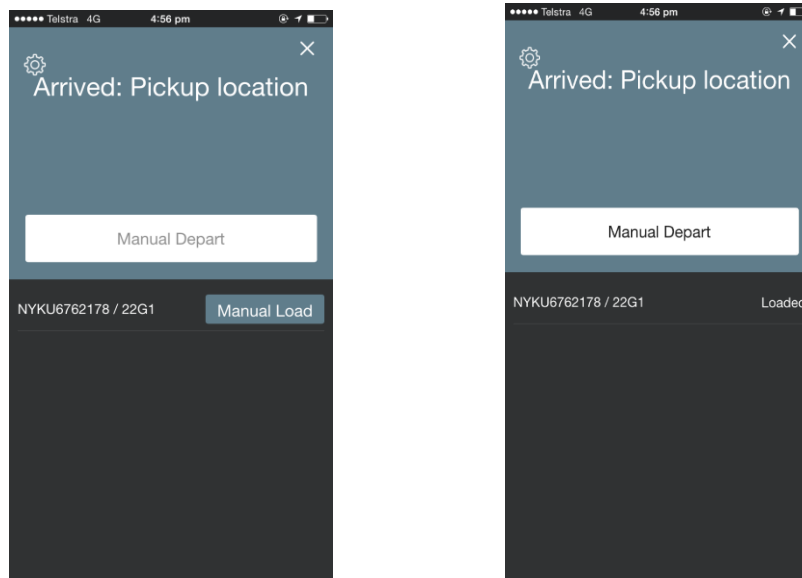

3.1.1 Green Lane - Approach and Arrival

As you drive towards the dehire location, there will be two geofences that are crossed, the approach geofence and the boundary geofence.

The approach geofence is a virtual barrier that the app picks up a set distance away from the empty container depot (Approx. 2.5 to 5km away).

The boundary geofence is another virtual barrier that the app picks up when entering the empty container depot.

When crossing either geofence, the app will automatically validate the job.

It will check the following:

- a. Container number
- b. Notification number
- c. Notification time window
- d. De-hire EDI information

If all checks pass, you will get a 'Green Lane'. A green lane allows you to be processed through express methods.

When you arrive at the job location with a green lane, your notification will be automatically processed. The status of the job will change to 'Arrived'

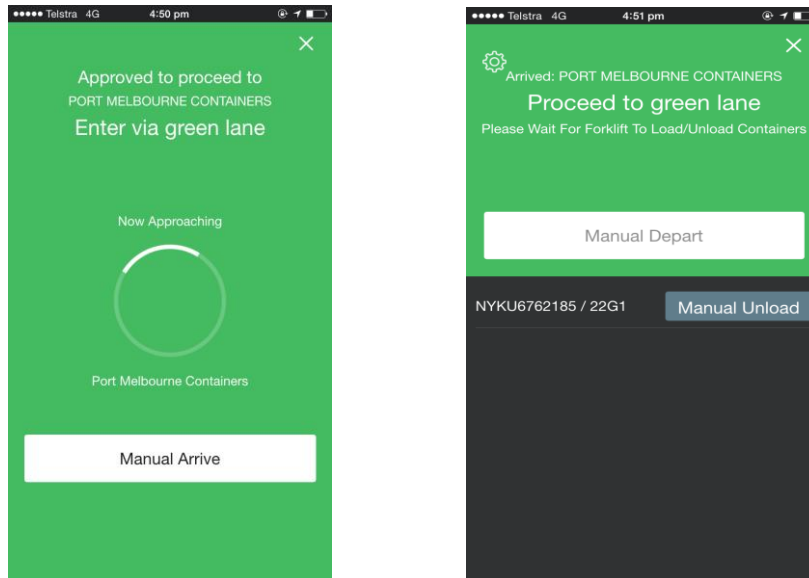

As the forklift operator unloads the container off your vehicle, the information they enter into their Forklift Mounted Terminal (FMT) will update the information in the driver app.

Once the job has been updated by the FMT, the job status will update to 'Unloaded' and when safe to do so, you will be authorised to depart the depot. Leaving the depot will depart you out the geofence and change the job status to 'Completed'.

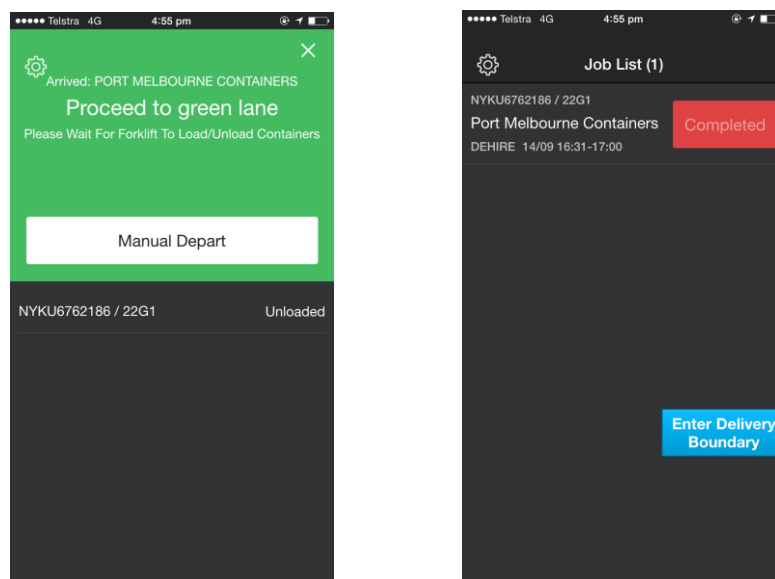

3.1.2 Red Lane - Approach and Arrival

On the approach and arrival to a Container Depot, if any or all checks fails then you will be shown a red lane. This means that you will need to be processed manually by the container depot. The process of completing a manual transaction will be explained through the container depots 'Carrier Access Arrangement'

When you arrive at the job location with a red lane, your notification will not be automatically processed. You will be required to follow depot instruction, and may be asked to provide relevant paperwork. Press the 'Arrive' button after being manually processed into the Depot.

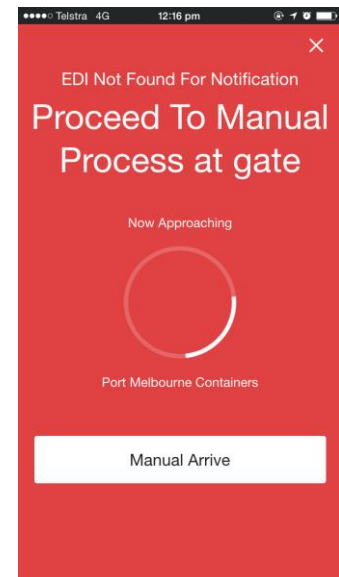

The Forklift Operator will then unload the container off your vehicle, the information they enter into their Forklift Mounted Terminal (FMT) may update the information in the driver app. If it does not update the information automatically, you will need to press 'Manual Unload' to update the job status to 'Unloaded'. Leaving the depot will depart you out the geofence and change the job status to 'Completed'.

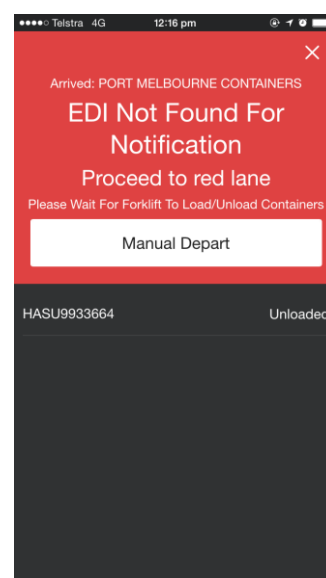
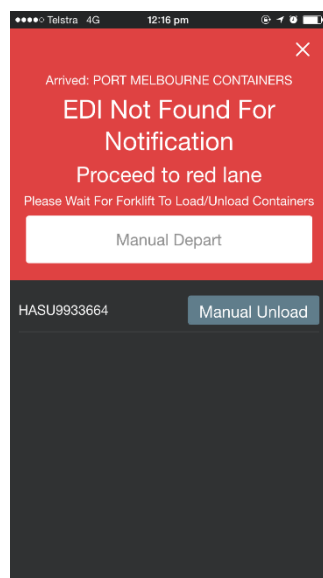

3.2 Pick up Notification

When a Fleet Controller enters a pickup notification into the Containerchain notification website, the job is automatically sent to the app logged in under that truck registration. To accept a job, tap 'Start' button. A prompt will appear and ask if you are sure you want to accept & start selected jobs, press yes to continue.

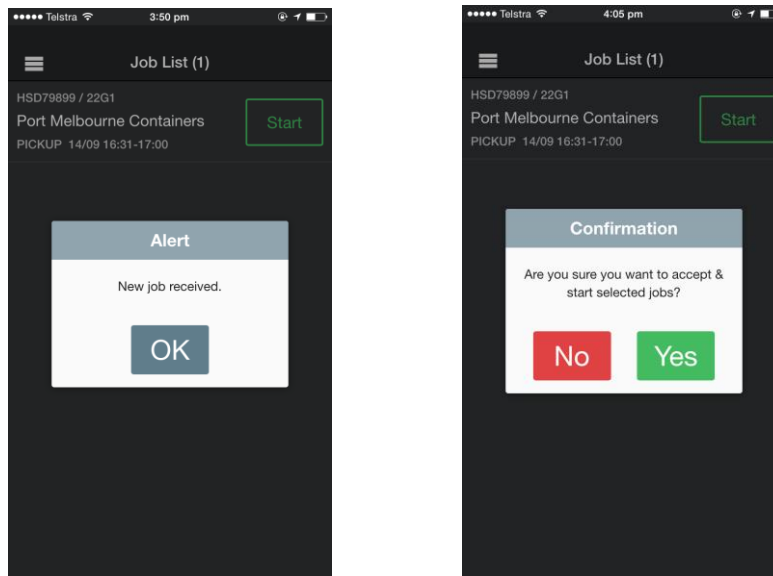

3.2.1 Green Lane- Approach and Arrival

As you drive towards the pickup location, there will be two geofences that are crossed, the approach geofence and the boundary geofence.

The approach geofence is a virtual barrier that the app picks up a set distance away from the empty container depot (Approx. 2.5 to 5km away).

The boundary geofence is another virtual barrier that the app picks up when entering the empty container depot.

When crossing either geofence, the app will automatically validate the job.

It will check the following:

- a. Notification number
- b. Notification time window
- c. Release number
- d. Release availability

If all checks pass, you will get a 'Green Lane'. A green lane allows you to be processed through express methods.

When you arrive at the job location with a green lane, your notification will be automatically processed. The status of the job will change to 'Arrived'

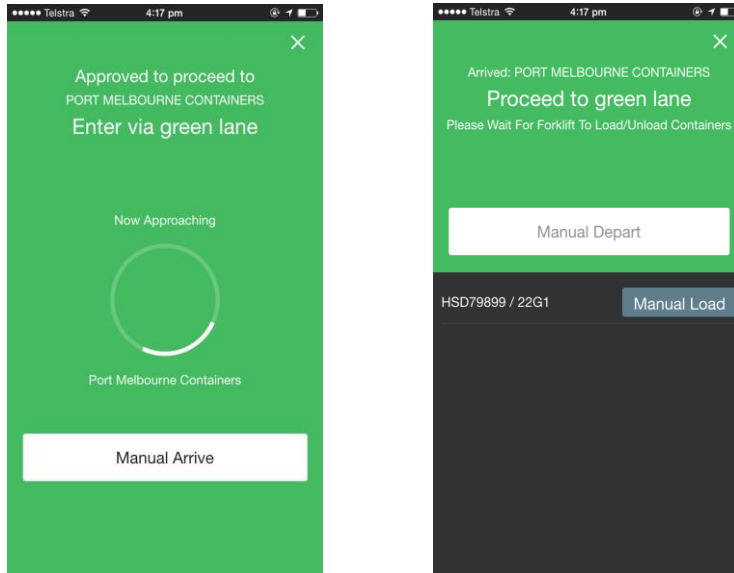

As the forklift operator loads the container onto your vehicle, the information they enter into their Forklift Mounted Terminal (FMT) will update the information in the driver app.

Once the job has been updated by the FMT, the status of the job will change to 'loaded' and when safe to do so, you will be authorised to depart. Leaving the depot will remove you out the geofence and change the job status to 'Completed'.

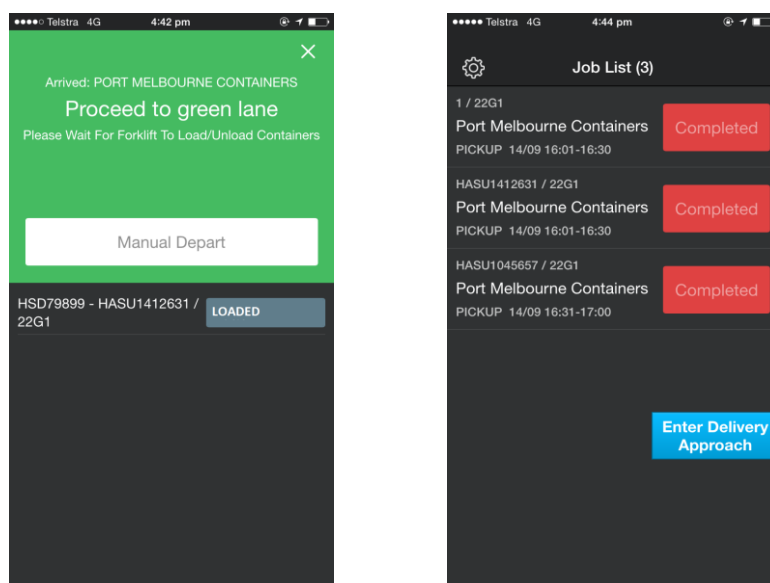

3.2.2 Red Lane - Approach and Arrival

On the approach and arrival to a Container Depot, if any or all checks fails then you will be shown a red lane. This means that you will need to be processed manually by the container depot. The process of completing a manual transaction will be explained through the container depots 'Carrier Access Arrangement'

When you arrive at the job location with a red lane, your notification will not be automatically processed. You will be required to follow depot instruction, and may be asked to provide relevant paperwork. Press the 'Arrive' button after being manually processed into the Depot.

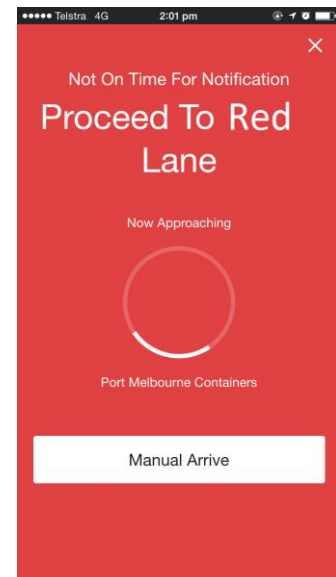

The Forklift Operator will then load the container onto your vehicle, the information they enter into their Forklift Mounted Terminal (FMT) may update the information in the Driver app. If it does not update the information automatically you will need to press 'Manual Load' and enter the container number and press 'OK'. This will update the job status to 'loaded'. Leaving the depot will depart you and change the job status to 'Completed'.

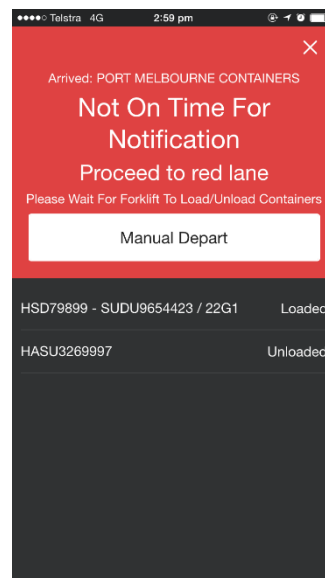
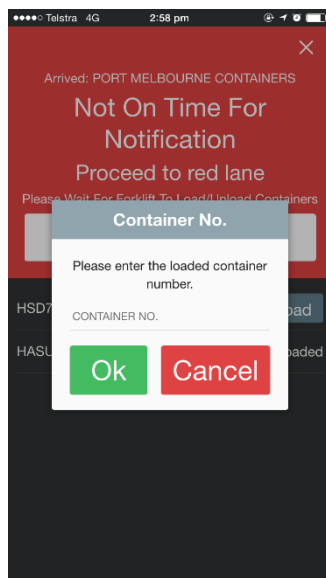

3.3 Multiple Jobs

When a Fleet Controller enters multiple notifications into the Containerchain notification website against one truck registration, the jobs are automatically sent to the app. To accept a jobs, Tap 'Start' button.

Once you start the first job, a prompt message will appear explaining that there are other jobs available. You can tap 'Start All Jobs' to start all available jobs to that location, or you could also press the 'Start' button next to the additional jobs you wish to start. Press 'X' to exit and continue.

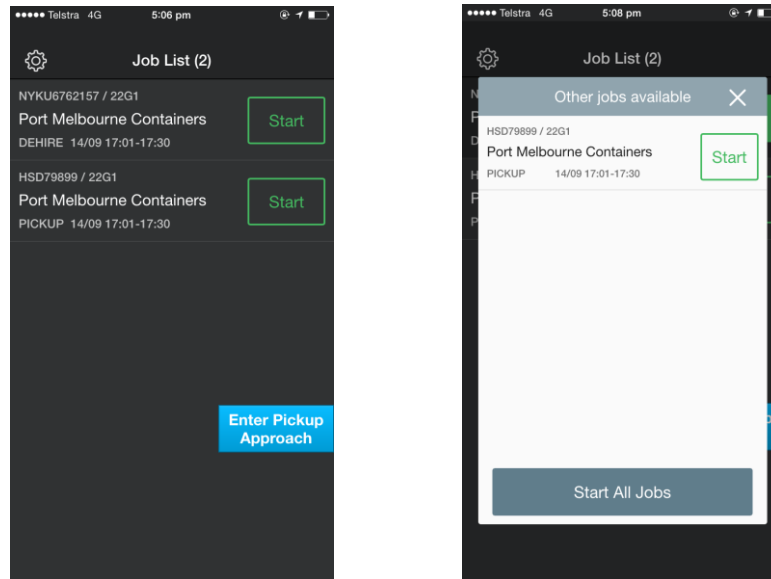

3.3.1 Green Lane - Approach and Arrival

As you drive towards the job location, there will be two geofences that are crossed, the approach geofence and the boundary geofence.

When crossing either geofence, the app will automatically validate the job.

It will check the following:

- a. Notification number
- b. Notification time window
- c. Release number
- d. Release availability
- e. Dehire EDI information
- f. Container number

If all checks pass, you will get a 'Green Lane'. A green lane allows you to be processed through express methods.

When you arrive at the job location with a green lane, your notification will be automatically processed. The status of the job will change to 'Arrived'

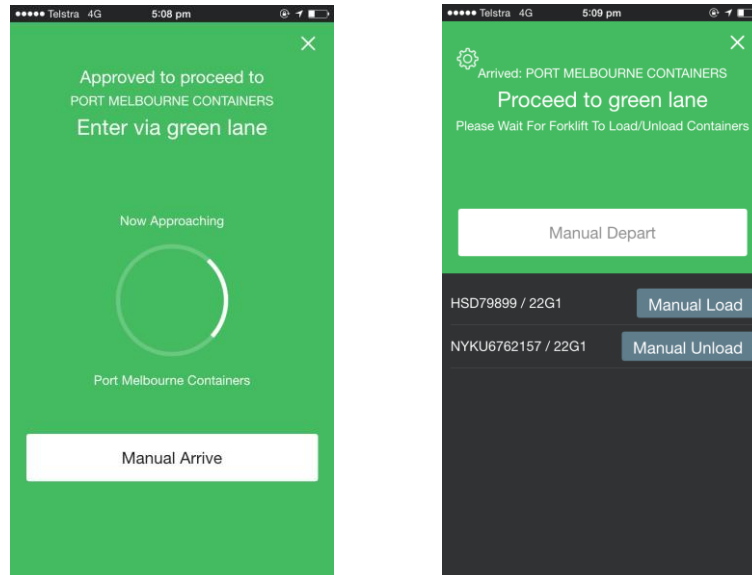

As the Forklift Operator unloads/loads the container, the Driver app will update and show that you have been 'Unloaded' or 'Loaded'. Once all jobs are updated, leaving the depot will remove you out the geofence and change the job status to 'Completed'.

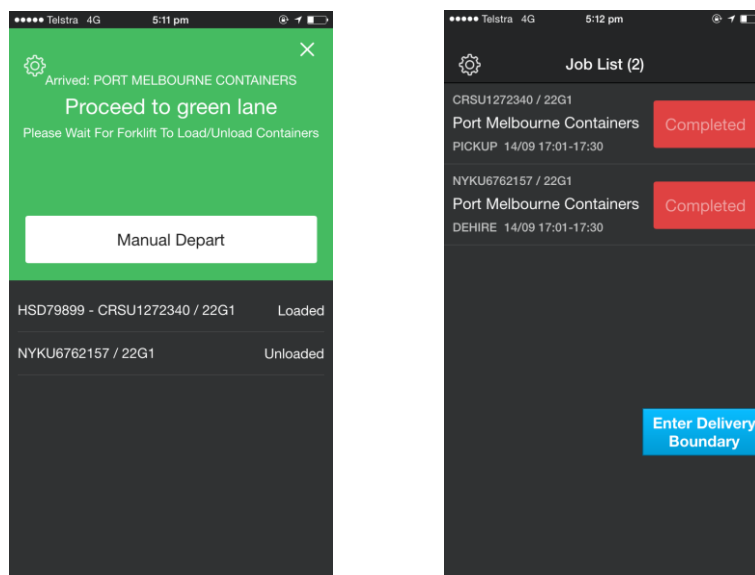

3.3.2 Red Lane- Approach and Arrival

On the approach and arrival to a container depot, if a check fails then a red lane will be presented. This means that you will need to be processed manually by the container depot. The process of completing a manual transaction will be explained through the container depots 'Carrier Access Arrangement'

When you arrive at the job location with a red lane, your notification will not be automatically processed. You will be required to follow depot instruction, and possibly provide relevant paperwork. Press the 'Arrive' button after being manually processed into the Depot.

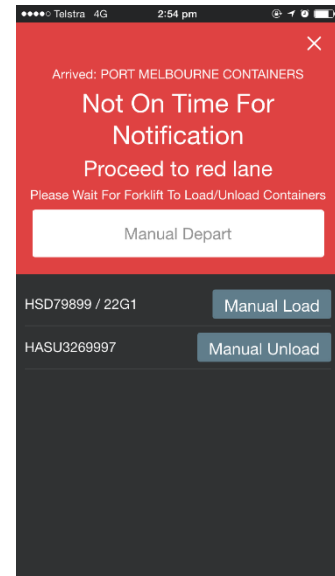

The Forklift Operator will then unload/load the container and the information they enter into their Forklift Mounted Terminal (FMT) may update the information in the Driver app. If it does not update the information automatically, for a pickup you will need to press 'Manual Load' and enter the container number to update the job status to 'loaded'. For a dehire tap 'Manual Unload' to update the job status to 'Unloaded'. Once all jobs are updated, leaving the depot will depart you and change the job status to 'Completed'.

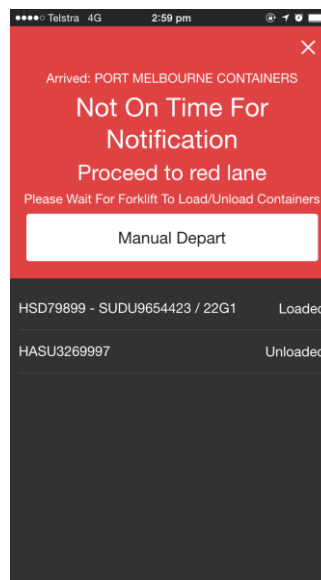
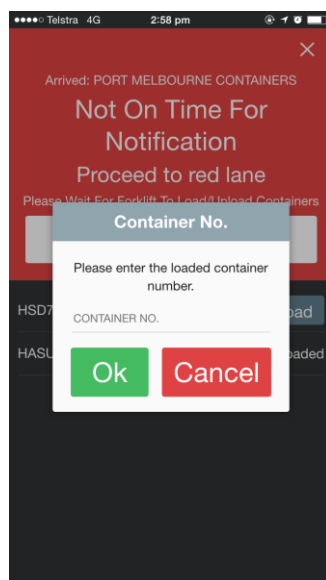

3.4 Rejecting a Job

To reject a job, highlight the job you wish to reject by tapping on that job line. This will take you to a detailed job description. Pressing the 'Action Job' button will prompt a message "Ready to Action Job?" Press the 'Reject' button to reject and continue.

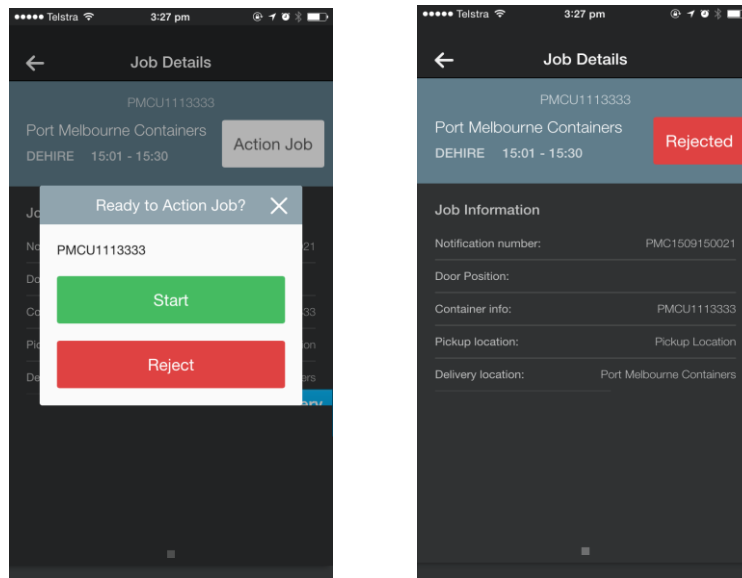

3.5 Logout

On the top left of the screen select  button

This will bring up the setting menu, select 'Logout' button.
A prompt will appear to confirm.

Selecting 'Yes' logs out the user.
Selecting 'No' cancels the logout.

